

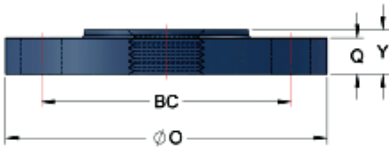

Cast Iron Threaded Flange for use on Steel Pipes



STANDARD COMPANION FLANGE Cast Iron #306



Nominal Size	Product No.	BC	O	Q	Y	Bolt Holes		Wgt.
						No.	Size	
1	306-100-0425	3.12	4-1/4	7/16	11/16	4	0.62	1.75
1-1/4	306-125-0463	3.50	4-5/8	1/2	13/16	4	0.62	2.00
1-1/2	306-150-0500	3.88	5	9/16	7/8	4	0.62	2.25
2	306-200-0600	4.75	6	5/8	1	4	0.75	4.00
2-1/2	306-250-0700	5.50	7	11/16	1-1/8	4	0.75	6.00
3	306-300-0750	6.00	7-1/2	3/4	1-3/16	4	0.75	7.63
3-1/2	306-350-0850	7.00	8-1/2	13/16	1-1/4	8	0.75	9.50
4	306-400-0900	7.50	9	15/16	1-5/16	8	0.75	11.75
5	306-500-1000	8.50	10	15/16	1-7/16	8	0.88	14.00
6	306-600-1100	9.50	11	1	1-9/16	8	0.88	16.50
8	306-800-1350	11.75	13-1/2	1-1/8	1-3/4	8	0.88	26.00
10	306-1000-1600	14.25	16	1-3/16	1-15/16	12	1.00	3800
12	306-1200-1900	17.00	19	1-1/4	2-3/16	12	1.00	51.00

REDUCING COMPANION FLANGE Cast Iron #316

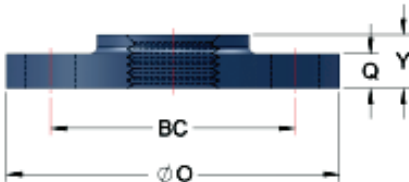

Nominal Size		Product No.	Thread Size	BC	O	Q	Y	Bolt Holes		Weight
Pipe x O.D.	Flg. x Pipe							No.	Size	
1 x 5	1-1/2 x 1	316-100-0500	1				11/16	4	0.62	2.75
1-1/4 x 5	1-1/2 x 1-1/4	316-125-0500	1-1/4	3.88	5	9/1	13/16	4	0.62	2.50
1 x 6	2 x 1	316-100-0600	1				11/16			5.00
1-1/4 x 6	2 x 1-1/4	316-125-0600	1-1/4	4.75	6	5/8	13/16	4	0.75	4.75
1-1/2 x 6	2 x 1-1/2	316-150-0600	1-1/2				7/8			4.50
1-1/2 x 7	2-1/2 x 1-1/2	316-150-0700	1-1/2	5.50	7	11/16	7/8	4	0.75	7.00
2 x 7	2-1/2 x 2	316-200-0700	2				1			6.75
1 x 7-1/2	3 x 1	316-100-0750	1				13/16			9.00
1-1/2 x 7-1/2	3 x 1-1/2	316-150-0750	1-1/2				7/8			8.75
2 x 7-1/2	3 x 2	316-200-0750	2	6.00	7-1/2	3/4	1	4	0.75	8.50
2-1/2 x 7-1/2	3 x 2-1/2	316-250-0750	2-1/2				1-1/8			8.00
1-1/2 x 9	4 x 1-1/2	316-150-0900	1-1/2				1			14.75
2 x 9	4 x 2	316-200-0900	2				1			14.00
2-1/2 x 9	4 x 2-1/2	316-250-0900	2-1/2	7.50	9	15/16	1-1/8	8	0.75	13.50
3 x 9	4 x 3	316-300-0900	3				1-3/16			12.75
2 x 10	5 x 2	316-200-1000	2				1			18.00
3 x 10	5 x 3	316-300-1000	3	8.50	10	15/16	1-3/16	8	0.88	17.00
4 x 10	5 x 4	316-400-1000	4				1-5/16			16.00
1-1/2 x 11	6 x 1-1/2	316-150-1100	1-1/2				1-1/16			27.00
2 x 11	6 x 2	316-200-1100	2				1-1/16			26.00
2-1/2 x 11	6 x 2-1/2	316-250-1100	2-1/2	9.50	11	1	1-1/8	8	0.88	25.00
3 x 11	6 x 3	316-300-110	3				1-3/16			23.00
4 x 11	6 x 4	316-400-1100	4				1-5/16			21.00
5 x 11	6 x 5	316-500-1100	5				1-7/16			19.00
2 x 13-1/2	8 x 2	316-200-1350	2				1-3/16			4.00
3 x 13-1/2	8 x 3	316-300-1350	3				1-3/16			40.00
4 x 13-1/2	8 x 4	316-400-1350	4	11.75	13-1/2	1-1/8	1-5/16	8	0.88	37.00
5 x 13-1/2	8 x 5	316-500-1350	5				1-7/16			34.00
6 x 13-1/2	8 x 6	316-600-1350	6				1-9/16			31.00
2 x 16	10 x 2	316-200-1600	2				1-15/16			61.00
4 x 16	10 x 4	316-400-1600	4				1-15/16			57.00
6 x 16	10 x 6	316-600-1600	6	14.25	16	1-3/16	1-15/16	12	1.00	53.00
8 x 16	10 x 8	316-800-1600	8				1-15/16			50.00
2 x 19	12 x 2	316-200-1900	2				2-3/16			84.00
4 x 19	12 x 4	316-400-1900	4				2-3/16			86.00
6 x 19	12 x 6	316-600-1900	6	17.00	19	1-1/4	2-3/16	12	1.00	88.00
8 x 19	12 x 8	316-800-1900	8				2-3/16			81.00
10 x 19	12 x 10	316-1000-1900	10				2-3/16			72.00

Dimensions in inches

Design and materials are subject to change without notice.



United Water Products
8710 Air Park West Drive, Charlotte, NC 28214
TEL. 401-250-3800

Website: www.unitedwaterproducts.com